



1.5 Ton Lever Chain Hoist 10 ft G80 Chain

Key features

- **Lifting Capacity:** Supports loads up to 1.5 tons (3,000 lbs), making it suitable for various lifting and pulling operations.
- **Lifting Height:** Features a 10-foot chain, providing ample reach for diverse applications and enhanced flexibility.
- **Robust Construction:** Built from high-quality materials to withstand rigorous use, ensuring long-lasting durability. Certified by TUV Rheinland
- CE Certified by TUV Rheinland
- 3 Year Warranty, Customer Support and Service in the USA

Lever Chain Hoist Description

The 1.5 Ton Lever Chain Hoist is a versatile and durable lifting solution designed for moderate to heavy-duty applications. With a lifting capacity of 1.5 tons (3,000 lbs) and a 10-foot G80 chain, this hoist is ideal for a wide range of tasks in industrial, commercial, and construction settings.

Prowinch Lever Chain Hoist

All of our **Lever Chain Hoists** are created with the goal of offering the best price-performance ratio. Key components such as lifespan factors are constantly tested and improved in order to offer the best product for the price.

Braking System

The reliable double pawl brake system is tested at 125% of the hoist capacity.

Technical Specifications

Rated Load Capacity	3300 lb / 1500 kg	Load Chain Size	Ø 8 mm
Standard Lifting Height	5 ft / 1.5 m	Chain Falls	1
Lever Force	49 lbs / 22 kg	Standards Compliance	ANSI/ASME B30.21, EN13157, ISO 16877-2008
Load Chain Type	G80	Warranty	3 Year

MODEL	PWYAL025	PWYAL050	PWYAL075	PWYAL100	PWYAL150	PWYAL300	PWYAL600	PWYAL900
A	3.1 in / 78.5mm	3.7 in / 95mm	5.8 in / 148mm		6.8 in / 172mm	7.9 in / 200mm		
B	2.4 in / 62mm	2.7 in / 68mm	3.5 in / 90mm		3.9 in / 98mm	4.5 in / 115mm		
C	1.4 in / 36mm	1.7 in / 42mm	1.5 in / 37mm	1.7 in / 45mm	1.9 in / 47mm	2.5 in / 63mm	3.1 in / 78mm	
D	5.9 in / 150mm	8.4 in / 215mm	11 in / 280mm		16.1 in / 410mm			
E	0.8 in / 21mm	0.9 in / 24.5mm	1.1 in / 28mm	1.2 in / 33mm	1.5 in / 33.5mm	1.7 in / 43.5mm	2.0 in / 51mm	2.5 in / 64mm
H	8.3 in / 210mm	10 in / 255mm	12.7 in / 325mm	12.7 in / 325mm	15 in / 380mm	19 in / 480mm	24.5 in / 620mm	27 in / 690mm

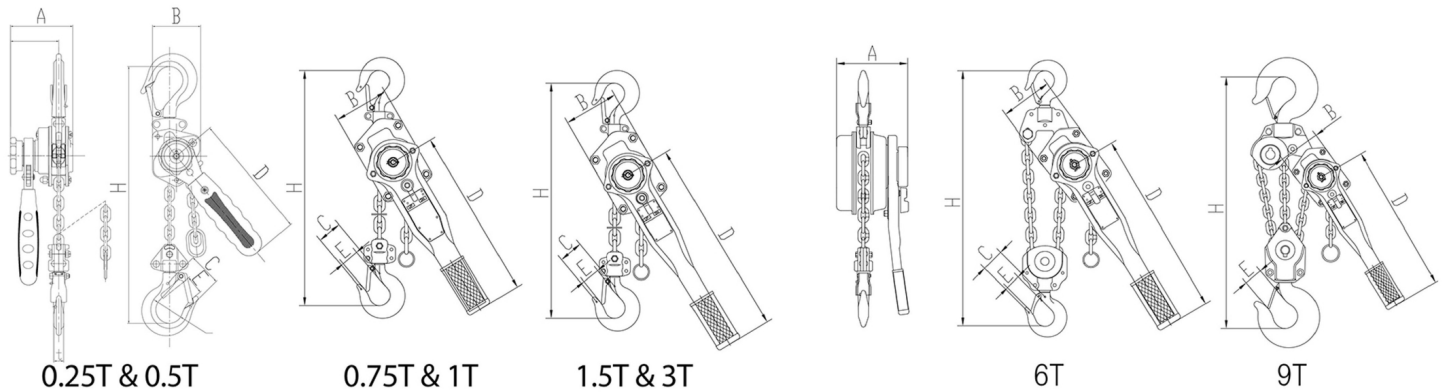

Unit Weight & Dimensions

Total Unit Weight 24 lbs / 11 Kg

Packaging Weight & Dimensions

Package 1 Net Weight 24 lbs / 11 Kg

Package 1 Width 6 in / 15.24 cm

Package 1 Gross Weight 26 lbs / 12 Kg

Package 1 Height 8 in / 20.32 cm

Package 1 Length 20 in / 50.8 cm