



1 Ton Lever Chain Hoist 5 ft. G80 Chain

Key features

- **Lifting Capacity:** Supports loads up to 1 ton (2,000 lbs), making it suitable for a range of lifting and pulling operations.
- **Durable G80 Chain:** Equipped with high-strength G80 chain for enhanced safety and reliability during lifting.
- **User-Friendly Operation:** The lever mechanism enables smooth and precise control while lifting or lowering loads.
- **CE Certified by TUV Rheinland**
- **3 Year Warranty, Customer Support and Service in the USA**

Lever Chain Hoist Description

The 1 Ton Lever Chain Hoist is a robust and reliable lifting solution designed for moderate lifting tasks. With a lifting capacity of 1 ton (2,000 lbs) and a 5-foot G80 chain, this hoist is perfect for various applications in industrial and commercial settings.

Prowinch Lever Chain Hoist

All of our **Lever Chain Hoists** are created with the goal of offering the best price-performance ratio. Key components such as lifespan factors are constantly tested and improved in order to offer the best product for the price.

Braking System

The reliable double pawl brake system is tested at 125% of the hoist capacity.

Technical Specifications

Rated Load Capacity	2200 lb / 1000 kg	Load Chain Size	Ø 6 mm
Standard Lifting Height	5 ft / 1.5 m	Chain Falls	1
Lever Force	40 lbs / 18 kg	Standards Compliance	ANSI/ASME B30.21, EN13157, ISO 16877-2008
Load Chain Type	G80	Warranty	3 Year

MODEL	PWYAL025	PWYAL050	PWYAL075	PWYAL100	PWYAL150	PWYAL300	PWYAL600	PWYAL900
A	3.1 in / 78.5mm	3.7 in / 95mm	5.8 in / 148mm		6.8 in / 172mm	7.9 in / 200mm		
B	2.4 in / 62mm	2.7 in / 68mm	3.5 in / 90mm		3.9 in / 98mm	4.5 in / 115mm		
C	1.4 in / 36mm	1.7 in / 42mm	1.5 in / 37mm	1.7 in / 45mm	1.9 in / 47mm	2.5 in / 63mm	3.1 in / 78mm	
D	5.9 in / 150mm	8.4 in / 215mm	11 in / 280mm		16.1 in / 410mm			
E	0.8 in / 21mm	0.9 in / 24.5mm	1.1 in / 28mm	1.2 in / 33mm	1.5 in / 33.5mm	1.7 in / 43.5mm	2.0 in / 51mm	2.5 in / 64mm
H	8.3 in / 210mm	10 in / 255mm	12.7 in / 325mm	12.7 in / 325mm	15 in / 380mm	19 in / 480mm	24.5 in / 620mm	27 in / 690mm

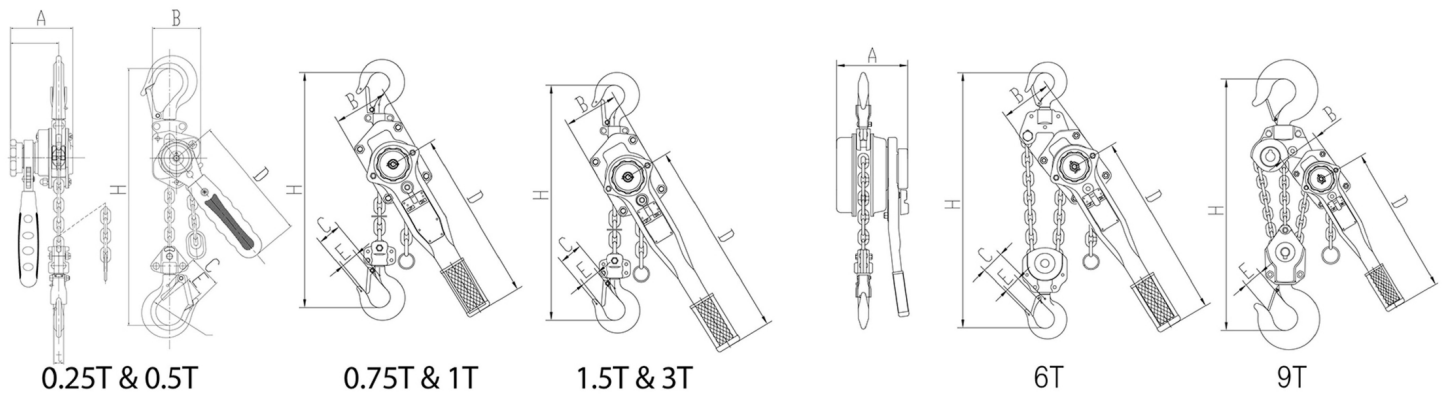

Unit Weight & Dimensions

Total Unit Weight	13 lbs / 6 Kg
--------------------------	---------------

Packaging Weight & Dimensions

Package 1 Net Weight	13 lbs / 6 Kg
Package 1 Width	5 in / 12.7 cm
Package 1 Gross Weight	15 lbs / 7 Kg
Package 1 Height	6 in / 15.24 cm
Package 1 Length	16 in / 40.64 cm