



3/4 Ton Mini Lever Block Chain Hoist Ratchet 1500 lbs Load Capacity Chain Puller 5 ft. G80 Chain

Key features

- **Lifting Capacity:** Supports loads up to 3/4 ton (1,500 lbs), making it suitable for a variety of light to moderate lifting and pulling operations.
- **Lifting Height:** Features a 5-foot chain, providing adequate reach for many tasks.
- **User-Friendly Operation:** The simple lever mechanism allows for smooth and precise control while lifting or lowering loads.
- **3 Year Warranty, Customer Support and Service in the USA**

Mini Lever Block Chain Hoist Description

The 3/4 Ton Mini Lever Chain Hoist is a compact and efficient lifting solution designed for light to moderate lifting tasks. With a lifting capacity of 3/4 ton (1,500 lbs) and a 5-foot G80 chain, this hoist is ideal for various applications where space and portability are essential.

Prowinch Lever Chain Hoist

All of our **Lever Chain Hoists** are created with the goal of offering the best price-performance ratio. Key components such as lifespan factors are constantly tested and improved in order to offer the best product for the price.

Braking System

The reliable double pawl brake system is tested at 125% of the hoist capacity.

Technical Specifications

Rated Load Capacity	1650 lb / 750 kg	Load Chain Size	Ø 6 mm
Standard Lifting Height	5 ft / 1.5 m	Chain Falls	1
Lever Force	31 lbs / 14 kg	Standards Compliance	ANSI/ASME B30.21, EN13157, ISO 16877-2008
Load Chain Type	G80	Warranty	3 Year

MODEL	PWYAL025	PWYAL050	PWYAL075	PWYAL100	PWYAL150	PWYAL300	PWYAL600	PWYAL900
A	3.1 in / 78.5mm	3.7 in / 95mm	5.8 in / 148mm		6.8 in / 172mm	7.9 in / 200mm		
B	2.4 in / 62mm	2.7 in / 68mm	3.5 in / 90mm		3.9 in / 98mm	4.5 in / 115mm		
C	1.4 in / 36mm	1.7 in / 42mm	1.5 in / 37mm	1.7 in / 45mm	1.9 in / 47mm	2.5 in / 63mm	3.1 in / 78mm	
D	5.9 in / 150mm	8.4 in / 215mm	11 in / 280mm		16.1 in / 410mm			
E	0.8 in / 21mm	0.9 in / 24.5mm	1.1 in / 28mm	1.2 in / 33mm	1.5 in / 33.5mm	1.7 in / 43.5mm	2.0 in / 51mm	2.5 in / 64mm
H	8.3 in / 210mm	10 in / 255mm	12.7 in / 325mm	12.7 in / 325mm	15 in / 380mm	19 in / 480mm	24.5 in / 620mm	27 in / 690mm

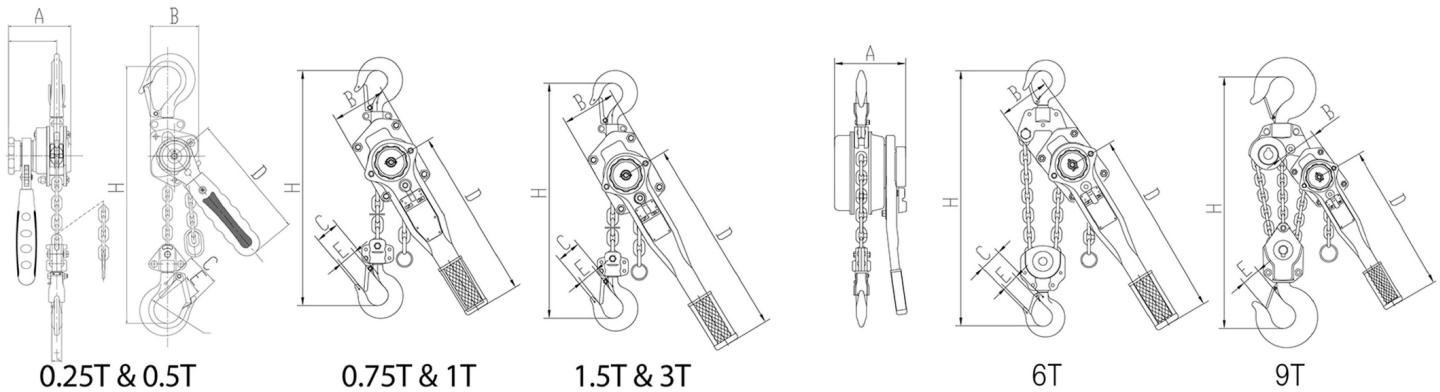

Unit Weight & Dimensions

Total Unit Weight 13 lbs / 6 Kg

Packaging Weight & Dimensions

Package 1 Net Weight 13 lbs / 6 Kg

Package 1 Width 5 in / 12.7 cm

Package 1 Gross Weight 15 lbs / 7 Kg

Package 1 Height 6 in / 15.24 cm

Package 1 Length 16 in / 40.64 cm