



1/2 Ton Mini Lever Chain Hoist 5 ft. G80 Chain

Key features

- Lever Chain Block Puller; Durable Black Tempered G80 Load Chain
- Reinforced Gear Cover, Zinc Plated Chain Guide and Side Plates
- Compact Design with Low Headroom Perfect for a Wide Range of Uses
- Reliable Double Pawl Brake System, Tested at 125% of Load Capacity
- 3 Year Warranty, Customer Support and Service in the USA

Lever Chain Hoist Description

The **Prowinch 1/4 ton Lever Chain Hoist** allows you to easily and safely lift loads up to 5 feet. It is perfect for warehouses, auto shops, and garages. The hoist is lightweight design and the convenient, durable hook allows the hoist to be quickly mounted wherever it is needed.

Prowinch Lever Chain Hoist

All of our **Lever Chain Hoists** are created with the goal of offering the best price-performance ratio. Key components such as lifespan factors are constantly tested and improved in order to offer the best product for the price.

Braking System

The reliable double pawl brake system is tested at 125% of the hoist capacity.

Technical Specifications

Rated Load Capacity	1100 lb / 500 kg	Load Chain Size	Ø 4 mm
Standard Lifting Height	5 ft / 1.5 m	Chain Falls	1
Lever Force	79 lbs / 36 kg	Standards Compliance	ANSI/ASME B30.21, EN13157, ISO 16877-2008
Load Chain Type	G80	Warranty	3 Year

MODEL	PWYAL025	PWYAL050	PWYAL075	PWYAL100	PWYAL150	PWYAL300	PWYAL600	PWYAL900
A	3.1 in / 78.5mm	3.7 in / 95mm	5.8 in / 148mm		6.8 in / 172mm	7.9 in / 200mm		
B	2.4 in / 62mm	2.7 in / 68mm	3.5 in / 90mm		3.9 in / 98mm	4.5 in / 115mm		
C	1.4 in / 36mm	1.7 in / 42mm	1.5 in / 37mm	1.7 in / 45mm	1.9 in / 47mm	2.5 in / 63mm	3.1 in / 78mm	
D	5.9 in / 150mm	8.4 in / 215mm	11 in / 280mm		16.1 in / 410mm			
E	0.8 in / 21mm	0.9 in / 24.5mm	1.1 in / 28mm	1.2 in / 33mm	1.5 in / 33.5mm	1.7 in / 43.5mm	2.0 in / 51mm	2.5 in / 64mm
H	8.3 in / 210mm	10 in / 255mm	12.7 in / 325mm	12.7 in / 325mm	15 in / 380mm	19 in / 480mm	24.5 in / 620mm	27 in / 690mm

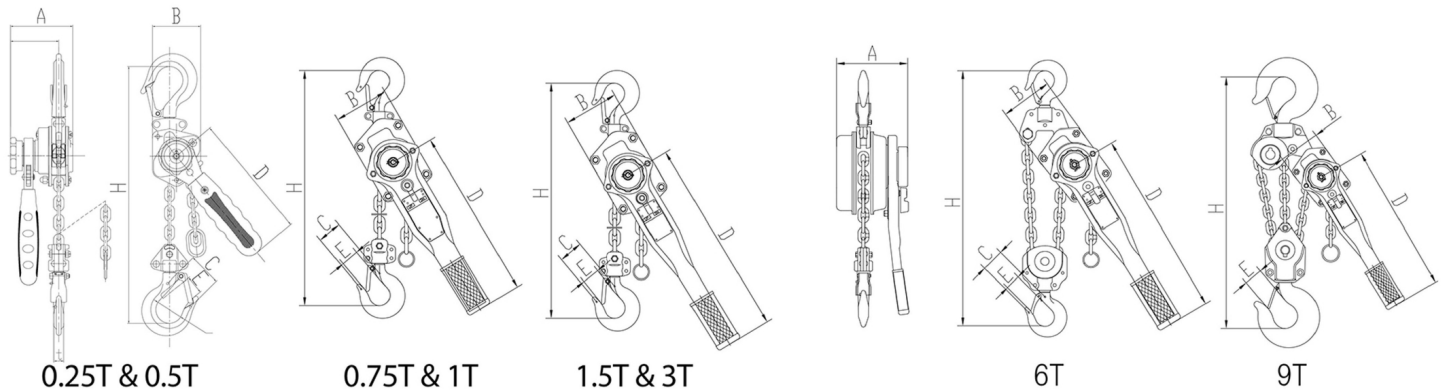

Unit Weight & Dimensions

Total Unit Weight	6 lbs / 3 Kg	Package 1 Net Weight	6 lbs / 3 Kg
		Package 1 Width	4 in / 10.16 cm
		Package 1 Gross Weight	4 lbs / 2 Kg
		Package 1 Height	4 in / 10.16 cm
		Package 1 Length	11 in / 27.94 cm

Packaging Weight & Dimensions