

10 Ton Hydraulic Winch 22000 lbs.

Key features

- High Load Capacity: Capable of handling up to 10 tons (22,000 lbs) for heavy-duty applications.
- Hydraulic Power: Operates efficiently with hydraulic systems for smooth and reliable performance.
- Durable Construction: Built with robust materials to withstand demanding environments.
- 3 Year Warranty, Customer Support and Service in the USA

Winch Description

This heavy-duty 10 Ton Hydraulic Winch delivers an impressive 22,000 lbs capacity, designed for rigorous lifting and pulling tasks. Built for strength and durability, it ensures reliable performance in challenging conditions, making it ideal for demanding applications.

Technical Specifications

1st Layer Rated Capacity	22046 lb / 10000 kg	Accessories	Wirerope Tensioner Included
Speed (f/m) / min	23 ft / 7 m	Standards Compliance	SAE-J706. ASME B30.7
Number of Speeds	1 Speed	Warranty	3 Year
IEC Motor Protection	IP67	Oil Pressure	160 bar / 2320 psi
Free Spooling Clutch Type	Pneumatic	Oil Flow	18 gpm / 68.2 l/min
Wire Rope	ø5/8 in x 197 ft ø16mm x 60 m		

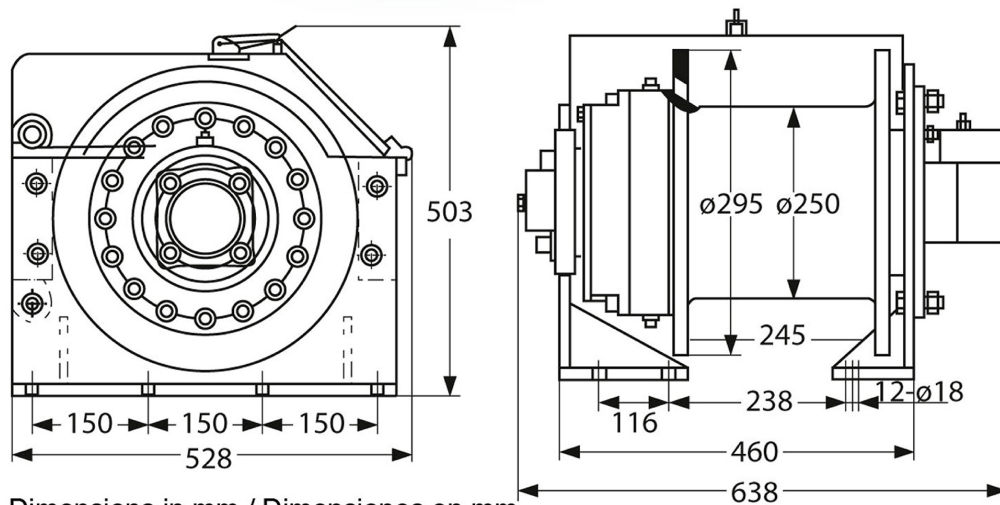
PWY100A

Dimensions in mm / Dimensiones en mm

Layers / Capas	m x Layer / Capa	Line Pull / Capacidad	Speed / Velocidad / min
1	44 ft / 13.3 m	22046 lb / 10000 kg	23 ft / 7.0 m
2	92 ft / 28.0 m	19678 lb / 8926 kg	26 ft / 7.8 m
3	145 ft / 44.2 m	17769 lb / 8060 kg	29 ft / 8.7 m
4	203 ft / 61.8 m	16199 lb / 7348 kg	31 ft / 9.5 m



Unit Weight & Dimensions

A Total Height	503 mm
Drum BD Barrel Diameter (58)	250 mm
D Depth	528 mm
Drum FD Flange Diameter (57)	295 mm
W Width	638 mm
Drum DL Length (56)	245 mm
Total Unit Weight	683 lbs / 310 Kg

Packaging Weight & Dimensions

Package 1 Net Weight	683 lbs / 310 Kg
Package 1 Width	30 in / 76.2 cm
Package 1 Gross Weight	727 lbs / 330 Kg
Package 1 Height	25 in / 63.5 cm
Package 1 Length	27 in / 68.58 cm