

660 lbs. Manual Winch Automatic Brake



Key features

- Load Capacity: Capable of handling up to 660 lbs, suitable for moderate lifting and pulling tasks.
- Automatic Brake: Features an automatic brake system to securely hold the load and prevent slippage.
- Manual Operation: Operates manually, providing a reliable option for use where power sources are unavailable.
- 1 Year Warranty, Customer Support and Service in the USA

Winch Description

This manual winch offers a 660 lbs capacity and is equipped with an automatic brake for enhanced safety and control. Engineered for reliable performance, it ensures secure handling of loads and smooth operation for various lifting and pulling tasks.

Technical Specifications

1st Layer Rated Capacity	660 lb / 300 kg	Drum Brake	Automatic
Number of Speeds	1 Speed	Recommended Wire Rope	ø1/4 in x 131 ft ø5 mm x 40 m
Motor Type (68)	Manual Crank	Standards Compliance	ASMEB30.7
Gear Ratio	6.67:1	Warranty	1 Year

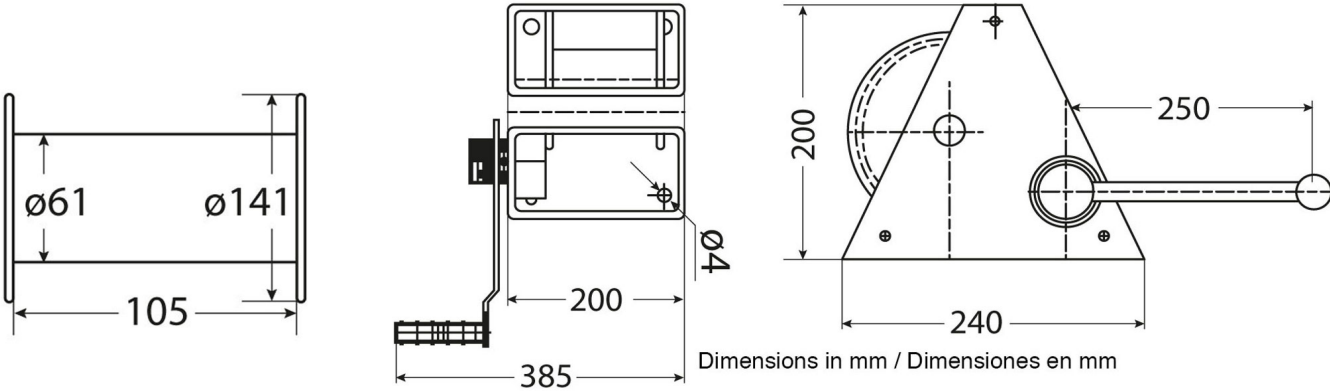

Unit Weight & Dimensions

Total Unit Weight	33 lbs / 15 Kg
--------------------------	----------------

Packaging Weight & Dimensions

Package 1 Net Weight	33 lbs / 15 Kg
Package 1 Width	11 in / 27.94 cm
Package 1 Gross Weight	35 lbs / 16 Kg
Package 1 Height	8 in / 20.32 cm
Package 1 Length	4 in / 10.16 cm