



## 1.5 Ton Air Hoist - RUD G80 Chain

### Key features

- 1.5 Ton Pneumatic Chain Hoist - Heavy Duty - Explosion Proof
- RUD G80 chain made in Germany (Lifting heights upon request)
- Includes: Overload Protection - Slip Clutch / Failsafe Automatic Internal Break / Pendant Control with emergency stop / Chain containers
- Meets and exceeds ASME B30.16 / HST-5 standards / Load Test at 130% SWL / ATEX Directive
- 3 Year Warranty, Customer Support and Service in the USA

**1.5 Ton Air Hoist - RUD G80 Chain - Overload Protection (other heights upon request) Includes Push button with emergency stop**

## Technical Specifications

<b>Rated Load Capacity</b>	1.5 Ton	<b>Emergency Stop</b>	Yes
<b>Standard Lifting Height</b>	30 ft / 9 m	<b>Operating Temperature Range</b>	-20°C to 70°C
<b>Number of Speeds</b>	1 Speed	<b>Air Pressure</b>	4 - 6 Bar
<b>Air Hoist Lifting Speed at Rated Load</b>	8.8 m/min	<b>Air Inlet Size</b>	3/4 BSP
<b>Air Hoist Lifting Speed Unloaded</b>	13.6 m/min	<b>Air hose dimension</b>	19mm - 25mm (3/4" - 1")19mm - 25mm (3/4" - 1")
<b>Air Hoist Lowering Speed at Rated Load</b>	13 m/min	<b>Air Consumption</b>	1.75 m3/min
<b>Maximum Safe Overload</b>	Overload Protection Slip Clutch 130% WLL	<b>Transmission / Reducer Type</b>	Epicycle Gearbox (Grease Filled and Sealed)
<b>Explosion Proof Protection</b>	- EX 2 GD IIA T4 - EX 2 GD IIB T4 - EXCLUDES Hydrogen Disulphide or Ethelene Oxide - ZONES 1, 2 AND 21, 22	<b>Load Chain Type</b>	G80 RUG Germany 5:1 Safety Factor
<b>Protection Exclusions</b>	- HYDROGEN DISULPHIDE - ETHELENE OXIDE	<b>Load Chain Size</b>	9 x 27 mm
<b>Control Distance</b>	16 ft / 5 m	<b>Chain Falls</b>	1
<b>Duty Class</b>	100% Duty Cycle	<b>Temperature</b>	-20°C to 70°C
<b>Motor/Engine Type</b>	Vane Rotary Motor - Lubrication Free - Rust Free & Replaceable Stainless Steel Cylinder	<b>Noise Level</b>	83 dBA @ 1m
<b>Motor/Engine Power</b>	1.4 kw	<b>Standards Compliance</b>	ASME B30.11 /B30.16 /HST-5 DIN EN818-7 SANS 1638 compliant ATEX EX Classification according to EC Directive on Hazardous Locations 94/9/EEC
<b>Motor Brake</b>	>125% WLL Automatic self-adjusting multidisc Brake	<b>Made in</b>	South Africa
<b>Control</b>	Pendant Control w/emergency stop	<b>Warranty</b>	3 Year

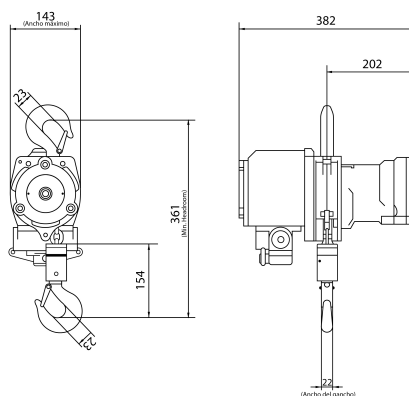

Dimensions in mm / Dimensiones en mm

## Unit Weight & Dimensions

<b>H Minimum Headroom</b>	361 mm
<b>W Width</b>	384 mm
<b>D Depth</b>	143 mm
<b>J Hook Opening</b>	25 mm