



2 Tons Air Chain Hoist with Trolley - ATEX Explosion Proof 10 m Lifting

Key features

- 2 Tons Pneumatic Chain Hoist - Heavy Duty - Explosion Proof
- RUD G80 chain made in Germany - 9 meters lifting height (other heights available upon request) Safety factor 5:1
- Includes: Multi-disc slip clutch load limiter / Pendant Control with emergency stop (8 meters) / Chain containers
- Meets and exceeds ASME B30.16 B30.17 / HST-5 standards / Load Test at 130% SWL / ATEX Directive
- 3 Year Warranty, Customer Support and Service in the USA

2 Tons Air Chain Hoist with Trolley - ATEX Explosion Proof 10 m Lifting

Technical Specifications

Rated Load Capacity	2 Ton	Air Inlet Size	1/2" BSP
Standard Lifting Height	20 ft / 6 m	Air hose dimension	13 mm (1/2")
Number of Speeds	1 Speed	Air Consumption	75 cfm / 2.1 m3/min
Air Hoist Lifting Speed at Rated Load	8.8 m/min	Transmission / Reducer Type	Epicycle Gearbox (Grease Filled and Seald)
Air Hoist Lifting Speed Unloaded	13 m/min	Load Chain Type	G80 RUG Germany 5:1 Safety Factor
Air Hoist Lowering Speed at Rated Load	13.5 m/min	Load Chain Size	9 x 27 mm
Maximum Safe Overload	Overload Protection Slip Clutch 130% WLL	Chain Falls	1
Explosion Proof Protection	EX 2 GD IIA T4 EX 2 GD IIB T4 EX 2 GD IIC T4 ZONES 1, 2 AND 21, 22 - Copper Coated: Chain hook, bottom block, Sprocket, Load sleeve, Safety Catch - Stainless Steel Wheels	Chain Length	9 m
Protection Exclusions	- HYDROGEN DISULPHIDE - ETHELENE OXIDE	Trolley Power	0.3 kW
Duty Class	100% Duty Cycle	Noise Level	84 dBA @ 1m
Motor/Engine Type	Vane Rotary Motor - Lubrication Free - Rust Free & Replaceable Stainless Steel Cylinder	Trolley Speed /min	12 m/min
Motor/Engine Power	1.4 kw	Trolley Number of Speeds	1
Motor Brake	>125% WLL Automatic self-adjusting multidisc Brake	I-Beam Width Range	65 - 280 mm
Control	Pendant Control 4 buttons w/emergency stop	Minimum Turn Radius	1.5 m
Emergency Stop	Yes, on pendant Control	Standards Compliance	ASME B30.11 / B30.16 / B30.17 / HST-5 DIN EN818-7 SANS 1638 compliant ATEX EX Classification according to EC Directive on Hazardous Locations 94/9/EEC
Operating Temperature Range	-20°C to 70°C	Made in	Southafrica
Air Pressure	4 - 6 Bar	Warranty	3 Year

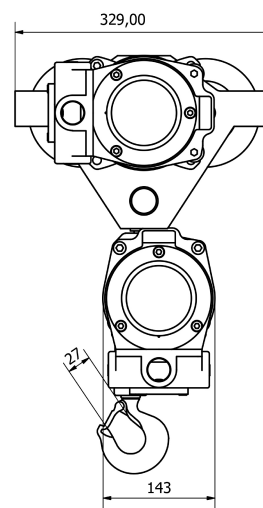
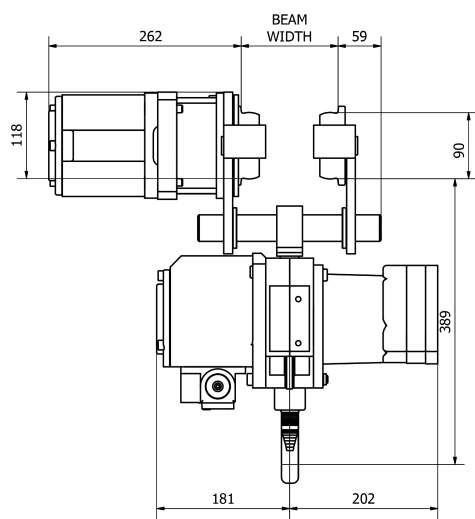

Unit Weight & Dimensions

H Minimum Headroom	402 mm
Total Unit Weight	135 lbs / 62 Kg

Packaging Weight & Dimensions

Package 1 Net Weight	135 lbs / 61 Kg
Package 1 Width	30 in / 76.2 cm
Package 1 Gross Weight	155 lbs / 70 Kg
Package 1 Height	26 in / 66.04 cm
Package 1 Length	46 in / 116.84 cm