

Permanent Magnetic Lifter 11000 lb. / 5000 kg

Key features

- **Load Capacity:** Safely lifts up to 11000 lbs (5000 kg), perfect for the most demanding lifting tasks.
- **Permanent Magnet Technology:** Utilizes advanced permanent magnets to securely hold ferrous materials without the need for external power.
- **Robust Construction:** Made from high-quality materials designed to withstand the rigors of heavy-duty operations, ensuring durability and reliability.
- **3 Year Warranty, Customer Support and Service in the USA**

Permanent Magnetic Lifter Description

The Permanent Magnetic Lifter 11000 lb. (5000 kg) is a powerful lifting tool engineered for heavy-duty applications. This lifter offers a secure grip on ferrous materials, making it ideal for use in manufacturing, construction, and other industrial environments that require the handling of substantial loads.

Technical Specifications

Rated Load Capacity	11000 lb / 5000 kg Max. pull off: 33070 lb / 15000 kg	Warranty	3 Year
Operating Temperature Range	<176°F / 80°C		

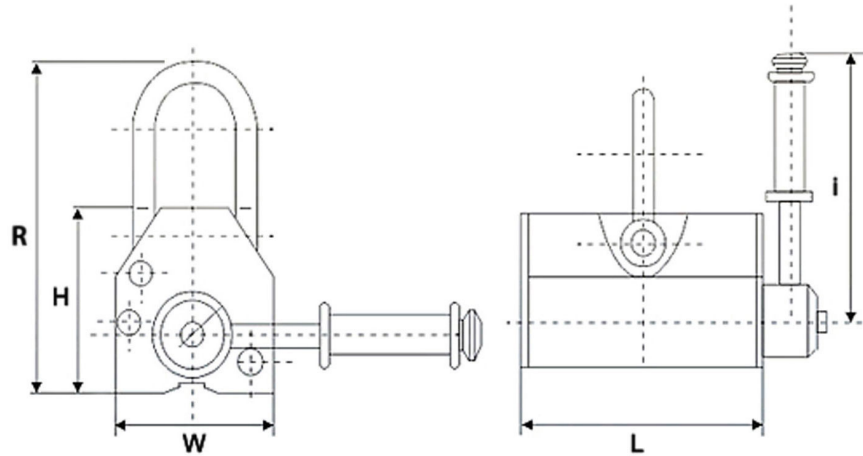

Model/Modelo	PWML100	PWML400	PWML600	PWML1000	PWML2000	PWML3000	PWML4000	PWML5000
Size / Tamaño								
L	4 in / 90 mm	6 in / 160 mm	9 in / 220 mm	10 in / 260 mm	13 in / 340 mm	17 in / 420 mm	19 in / 480 mm	23 in / 580 mm
W	3 in / 63.5 mm	4 in / 95 mm	5 in / 115 mm	6 in / 145 mm	6 in / 160 mm	7 in / 185 mm	8 in / 200 mm	12 in / 300 mm
H	3 in / 68 mm	7 in / 180 mm	5 in / 125 mm		6 in / 165 mm			
R	6 in / 145 mm	8 in / 210 mm	9 in / 230 mm	11 in / 280 mm	16 in / 410 mm	20 in / 510 mm		26 in / 650 mm
Magnet Activation	Locking ON/OFF Handle							
Activación del magneto	Palanca ON/OFF							

Unit Weight & Dimensions

Total Unit Weight 436 lbs / 198 Kg

Packaging Weight & Dimensions

Package 1 Net Weight 436 lbs / 198 Kg

Package 1 Width 15 in / 38.1 cm

Package 1 Gross Weight 469 lbs / 213 Kg

Package 1 Height 27 in / 68.58 cm

Package 1 Length 18 in / 45.72 cm