

## Permanent Magnetic Lifter 880 lb. / 400 kg

### Key features

- Load Capacity: Safely lifts loads up to 880 lbs (400 kg), suitable for medium-duty tasks.
- Permanent Magnet Technology: Utilizes strong permanent magnets to securely grip ferrous materials without the need for external power.
- User-Friendly Operation: Easy-to-use engagement and disengagement mechanism for quick and safe lifting.
- 3 Year Warranty, Customer Support and Service in the USA

### Permanent Magnetic Lifter Description

The Permanent Magnetic Lifter 880 lb. (400 kg) is a reliable and efficient lifting tool designed for handling ferrous materials in various industrial applications. This compact lifter ensures secure and safe lifting, making it ideal for manufacturing, construction, and warehousing environments.

### Technical Specifications

<b>Rated Load Capacity</b>	880 lb / 400 kg   Max. pull off: 2650 lb / 1200 kg	<b>Warranty</b>	3 Year
<b>Operating Temperature Range</b>	<176°F / 80°C		

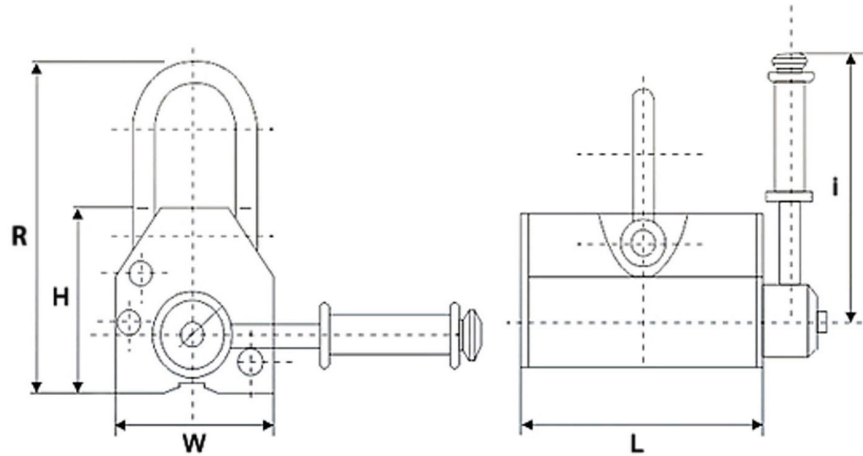

Model/Modelo	PWML100	PWML400	PWML600	PWML1000	PWML2000	PWML3000	PWML4000	PWML5000
L	4 in / 90 mm	6 in / 160 mm	9 in / 220 mm	10 in / 260 mm	13 in / 340 mm	17 in / 420 mm	19 in / 480 mm	23 in / 580 mm
W	3 in / 63.5 mm	4 in / 95 mm	5 in / 115 mm	6 in / 145 mm	6 in / 160 mm	7 in / 185 mm	8 in / 200 mm	12 in / 300 mm
H	3 in / 68 mm	7 in / 180 mm	5 in / 125 mm		6 in / 165 mm			
R	6 in / 145 mm	8 in / 210 mm	9 in / 230 mm	11 in / 280 mm	16 in / 410 mm	20 in / 510 mm		26 in / 650 mm
Magnet Activation	Locking ON/OFF Handle							
Activación del magneto	Palanca ON/OFF							

### Unit Weight & Dimensions

<b>Total Unit Weight</b>	22 lbs / 10 Kg
--------------------------	----------------

### Packaging Weight & Dimensions

<b>Package 1 Net Weight</b>	22 lbs / 10 Kg
<b>Package 1 Width</b>	7 in / 17.78 cm
<b>Package 1 Gross Weight</b>	26 lbs / 12 Kg
<b>Package 1 Height</b>	11 in / 27.94 cm
<b>Package 1 Length</b>	6 in / 15.24 cm