

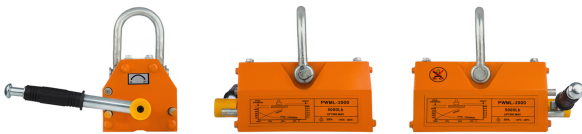

Permanent Magnetic Lifter 4400 lb. / 2000 kg

Key features

- Load Capacity: Safely lifts loads up to 4400 lbs (2000 kg), perfect for handling heavy materials.
- Durable Construction: Built from high-quality materials to ensure long-lasting durability and performance under heavy loads.
- Versatile Applications: Ideal for lifting steel plates, beams, and other ferrous items in various industrial settings.
- 3 Year Warranty, Customer Support and Service in the USA



Permanent Magnetic Lifter Description

The Permanent Magnetic Lifter is a robust and highly efficient lifting tool designed for heavy-duty applications, capable of lifting up to 4400 lbs (2000 kg). This lifter provides a secure grip on ferrous materials, making it ideal for use in industrial environments such as manufacturing, construction, and warehouses.

Technical Specifications

Rated Load Capacity	4400 lb / 2000 kg Max. pull off: 11000 lb / 5000 kg	Warranty	3 Year
Operating Temperature Range	<176°F / 80°C		

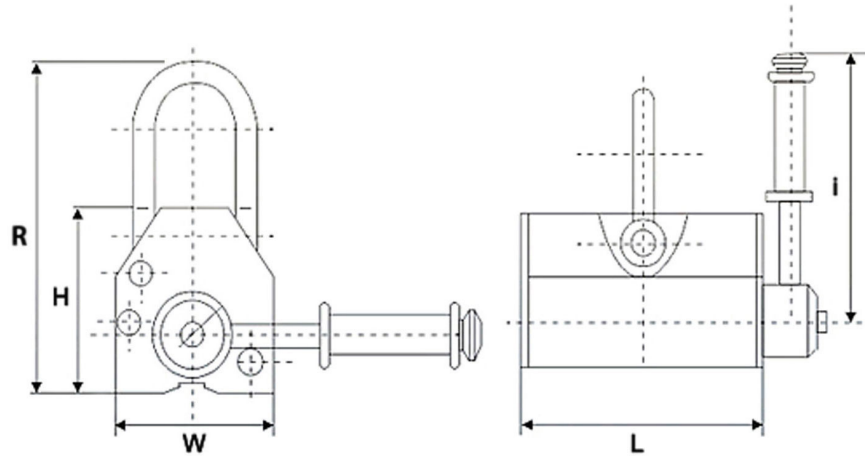

Model/Modelo	PWML100	PWML400	PWML600	PWML1000	PWML2000	PWML3000	PWML4000	PWML5000
L	4 in / 90 mm	6 in / 160 mm	9 in / 220 mm	10 in / 260 mm	13 in / 340 mm	17 in / 420 mm	19 in / 480 mm	23 in / 580 mm
W	3 in / 63.5 mm	4 in / 95 mm	5 in / 115 mm	6 in / 145 mm	6 in / 160 mm	7 in / 185 mm	8 in / 200 mm	12 in / 300 mm
H	3 in / 68 mm	7 in / 180 mm	5 in / 125 mm		6 in / 165 mm			
R	6 in / 145 mm	8 in / 210 mm	9 in / 230 mm	11 in / 280 mm	16 in / 410 mm	20 in / 510 mm		26 in / 650 mm
Magnet Activation	Locking ON/OFF Handle							
Activación del magneto	Palanca ON/OFF							

Unit Weight & Dimensions

Total Unit Weight 155 lbs / 71 Kg

Packaging Weight & Dimensions

Package 1 Net Weight 155 lbs / 70 Kg

Package 1 Width 19 in / 48.26 cm

Package 1 Gross Weight 147 lbs / 67 Kg

Package 1 Height 17 in / 43.18 cm

Package 1 Length 27 in / 68.58 cm