



Permanent Magnetic Lifter 220 lb. / 100 kg

Key features

- Load Capacity: Safely lifts up to 220 lbs (100 kg), perfect for handling heavy ferrous items.
- Permanent Magnet Technology: Utilizes strong permanent magnets to ensure a secure hold without the need for external power sources.
- Durable Construction: Made from high-quality materials, ensuring long-lasting performance and reliability.
- 3 Year Warranty, Customer Support and Service in the USA

Permanent Magnetic Lifter Description

The Permanent Magnetic Lifter is a powerful and efficient lifting tool designed for safely handling ferrous materials. With a lifting capacity of 220 lbs (100 kg), this lifter provides a secure and reliable grip for various applications in manufacturing, construction, and warehouses.

Technical Specifications

Rated Load Capacity	220 lb / 100 kg Max. pull off: 660 lb / 300 kg	Warranty	3 Year
Operating Temperature Range	<176°F / 80°C		

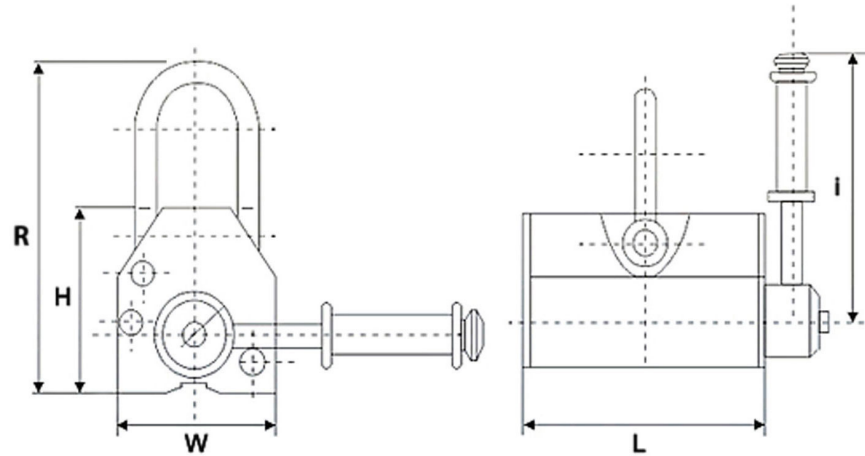

Model/Modelo	PWML100	PWML400	PWML600	PWML1000	PWML2000	PWML3000	PWML4000	PWML5000
L	4 in / 90 mm	6 in / 160 mm	9 in / 220 mm	10 in / 260 mm	13 in / 340 mm	17 in / 420 mm	19 in / 480 mm	23 in / 580 mm
W	3 in / 63.5 mm	4 in / 95 mm	5 in / 115 mm	6 in / 145 mm	6 in / 160 mm	7 in / 185 mm	8 in / 200 mm	12 in / 300 mm
H	3 in / 68 mm	7 in / 180 mm	5 in / 125 mm		6 in / 165 mm			
R	6 in / 145 mm	8 in / 210 mm	9 in / 230 mm	11 in / 280 mm	16 in / 410 mm	20 in / 510 mm		26 in / 650 mm
Magnet Activation	Locking ON/OFF Handle							
Activación del magneto	Palanca ON/OFF							

Unit Weight & Dimensions

Total Unit Weight	6 lbs / 3 Kg
--------------------------	--------------

Packaging Weight & Dimensions

Package 1 Net Weight	6 lbs / 3 Kg
Package 1 Width	6 in / 15.24 cm
Package 1 Gross Weight	8 lbs / 4 Kg
Package 1 Height	9 in / 22.86 cm
Package 1 Length	6 in / 15.24 cm