



20000 lbs Electric Winch Waterproof 12V DC Wireless

Key features

- Load Capacity: Capable of pulling up to 20,000 lbs, ideal for heavy-duty applications like vehicle recovery, towing, or off-road use.
- 12V DC Power: Operates on a 12V DC system, making it compatible with standard automotive or off-road vehicles.
- Waterproof Design: Built to withstand harsh weather conditions, ensuring reliable performance in wet or muddy environments.
- 1 Year Warranty, Customer Support and Service in the USA

Winch Description

This 20,000 lbs Electric Recovery Winch 12V will help you in any recovery situation. No matter the terrain this dependable winch is the key partner every rider needs. With a powerful 20,000lb load capacity and 6HP motor, this electric winch will give you the results you need. Use this winch with confidence as it includes a 3 Year Warranty.

Prowinch Electric DC Winches

All of our electric DC winches are created with the goal of offering the best price-performance ratio. Key components such as lifespan factors are constantly tested and improved in order to offer the best product for the price.

Key Components

All internal components have been upgraded to meet the highest quality standards. Key electronic components are produced by American or German brands, and we use American-made lubricants to ensure the lifespan of gears and reducers. Final assembly and all tests are performed locally at Prowinch facility before shipping to ensure that every unit meets the corresponding standard.

Control System

This winch includes a 12V wired remote control. The winch contains the best electric components available on the market, and everything is made, assembled, and tested locally in the US, Chile, or Colombia.

Braking System

Prowinch electric DC winches include a sliding ring gear clutch and an in drum automatic brake. Automatic brake system designed to automatically engage immediately upon any loss of power.

Technical Specifications

1st Layer Rated Capacity	20000 lbs	Control Voltage	12 V
Number of Layers	4	Electric Control Box	Reverse Solenoid Control Box
Speed (f/m) / min	3.4~17 ft / 1~5 m	Transmission / Reducer Type	4-Stage Planetary
Number of Speeds	1 Speed	Gear Ratio	544:1
Voltage	Battery Power 12 VDC	Drum Brake	In-Drum Automatic Brake
FCC ID	2ASYP-DW12K	Free Spooling Clutch Type	Sliding Ring Gear
Motor Type (68)	DC Series Wound Motor	Wire Rope	Steel \varnothing 9/16 in x 85 ft \varnothing 14 mm x 26 m
Motor AMP	450 AMP	Fairlead	Included
IEC Motor Protection	IP67	Accessories	Control and Installation Hardware
Control	Wireless and Wired	Warranty	1 Year

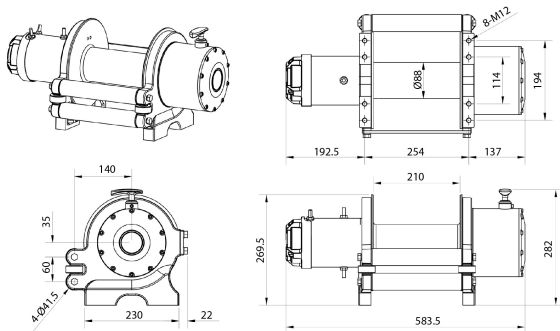

Dimensions in mm / Dimensiones en mm

INCLUDED / INCLUIDO



OPTIONAL / OPCIONAL



Unit Weight & Dimensions

A Total Height	335 mm	Package 1 Net Weight	188 lbs / 85 Kg
Drum BD Barrel Diameter (58)	89 mm	Package 1 Width	21 in / 53.34 cm
D Depth	285 mm	Package 1 Gross Weight	165 lbs / 75 Kg
Drum DL Length (56)	228 mm	Package 1 Height	20 in / 50.8 cm
W Width	560 mm	Package 1 Length	25 in / 63.5 cm
J Hook Opening	31 mm		
Total Unit Weight	188 lbs / 86 Kg		

Packaging Weight & Dimensions