



20000 lbs Electric Waterproof Winch Wire Rope 24V

Key features

- **Maximum Pulling Capacity:** Capable of handling 20,000 lbs for heavy-duty tasks, perfect for large trucks, off-road vehicles, and industrial applications.
- **24V DC Power:** Powered by a 24-volt system, providing enhanced torque and efficiency for demanding pulling operations.
- **Waterproof Design:** Fully waterproof construction ensures reliable performance in all weather conditions, including rain, mud, and snow.
- **1 Year Warranty, Customer Support and Service in the USA**

Winch Description

This Prowinch 20,000 lbs 24V Electric Winch offers ultimate pulling power. The winch is IP67 waterproof and comes with a handy wireless control, which make it perfect for a wide variety of uses such as off-roading and towing.

Prowinch 24V Electric Winch

All of our **AC electric winches** are created with the goal of offering the best price-performance ratio. Key components such as lifespan factors are constantly tested and improved in order to offer the best product for the price.

Key Components

All internal components have been upgraded to meet the highest quality standards. Final assembly and all tests are performed locally at Prowinch facility before shipping to ensure that every unit meets the corresponding standard.

Control System

These winches feature a unique remote control design, which allows the winch to be operated wired or wirelessly.

Braking System

Automatic brake system designed to automatically engage immediately upon any loss of power.

Technical Specifications

1st Layer Rated Capacity	20000 lbs	Control Voltage	24 V
Number of Layers	4	Electric Control Box	Reverse Solenoid Control Box
Speed (f/m) / min	3.4~17 ft / 1~5 m	Transmission / Reducer Type	4-Stage Planetary
Number of Speeds	1 Speed	Gear Ratio	544:1
Voltage	Battery Power 24 VDC	Drum Brake	Automatic
FCC ID	2ASYP-DW12K	Free Spooling Clutch Type	Sliding Ring Gear
Motor Type (68)	DC Series Wound Motor	Wire Rope	Steel ϕ 1/2 in x 72 ft ϕ 13 mm x 22 m
Motor AMP	323 AMP	Fairlead	Included
IEC Motor Protection	IP67	Accessories	Control and Installation Hardware
Control	Wireless and Wired	Warranty	1 Year

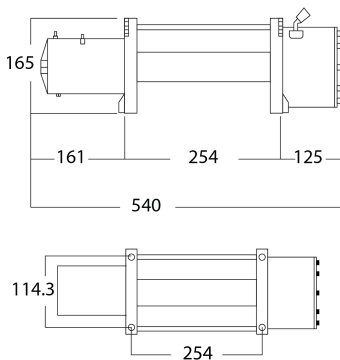

Dimensions in mm / Dimensiones en mm



INCLUDED/ INCLUIDO

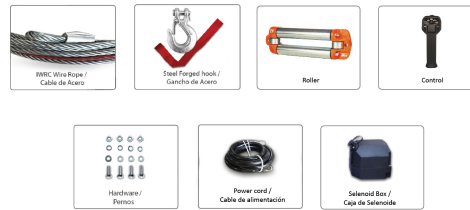

OPTIONAL / OPCIONAL



Unit Weight & Dimensions

Drum BD Barrel Diameter (58)	89 mm	Package 1 Net Weight	138 lbs / 63 Kg
Drum DL Length (56)	228 mm	Package 1 Width	23 in / 58.42 cm
Total Unit Weight	138 lbs / 63 Kg	Package 1 Gross Weight	143 lbs / 65 Kg
		Package 1 Height	12 in / 30.48 cm
		Package 1 Length	12 in / 30.48 cm

Packaging Weight & Dimensions