



20000 lbs Electric Waterproof Winch Wireless 12V DC

Key features

- High Load Capacity: Capable of pulling up to 20,000 lbs, making it ideal for heavy-duty applications like large trucks, SUVs, and industrial use.
- 12V DC Power: Operates on a 12-volt DC system, compatible with most vehicle electrical systems for convenient power access.
- Waterproof Construction: Built with a fully waterproof housing, ensuring performance in wet, muddy, and challenging environments without risk of damage.
- 1 Year Warranty, Customer Support and Service in the USA

Winch Description

Our 20,000 lbs Electric Waterproof Recovery Winch 12V is the ultimate winch for tough pulls. This winch has been tried and tested even in the most rugged conditions. With an impressive IP67 rating this winch can perform even when submerged in water of up to one meter. Helping you complete your recovery job with ease.

Prowinch Electric DC Winches

All of our electric DC winches are created with the goal of offering the best price-performance ratio. Key components such as lifespan factors are constantly tested and improved in order to offer the best product for the price.

Key Components

All internal components have been upgraded to meet the highest quality standards. Key electronic components are produced by American or German brands, and we use American-made lubricants to ensure the lifespan of gears and reducers. Final assembly and all tests are performed locally at Prowinch facility before shipping to ensure that every unit meets the corresponding standard.

Control System

This winch includes a 12V wired remote control. The winch contains the best electric components available on the market, and everything is made, assembled, and tested locally in the US, Chile, or Colombia.

Braking System

Prowinch electric DC winches include a sliding ring gear clutch and an in drum automatic brake. Automatic brake system designed to automatically engage immediately upon any loss of power.

Technical Specifications

1st Layer Rated Capacity	20000 lbs	Control Voltage	12 V
Number of Layers	4	Electric Control Box	Reverse Solenoid Control Box
Speed (f/m) / min	3.4~17 ft / 1~5 m	Transmission / Reducer Type	4-Stage Planetary
Number of Speeds	1 Speed	Gear Ratio	544:1
Voltage	Battery Power 12 VDC	Drum Brake	In-Drum Automatic Brake
FCC ID	2ASYP-DW12K	Free Spooling Clutch Type	Sliding Ring Gear
Motor Type (68)	DC Series Wound Motor	Wire Rope	Steel ϕ 1/2 in x 72 ft ϕ 13 mm x 22 m
Motor AMP	450 AMP	Fairlead	Included
IEC Motor Protection	IP67	Accessories	Control and Installation Hardware
Control	Wireless and Wired	Warranty	1 Year

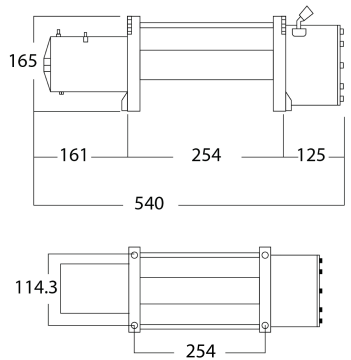

Dimensions in mm / Dimensiones en mm



INCLUDED/ INCLUIDO

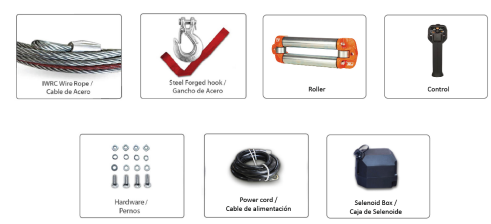

OPTIONAL / OPCIONAL



Unit Weight & Dimensions

Drum BD Barrel Diameter (58)	89 mm
J Hook Opening	31 mm
Drum DL Length (56)	228 mm
Total Unit Weight	138 lbs / 63 Kg

Packaging Weight & Dimensions

Package 1 Net Weight	138 lbs / 63 Kg
Package 1 Width	23 in / 58.42 cm
Package 1 Gross Weight	143 lbs / 65 Kg
Package 1 Height	12 in / 30.48 cm
Package 1 Length	12 in / 30.48 cm