



1/2 Ton Mini Lever Chain Hoist 10 ft. G100 Chain

Key features

- ISO 16872 Zinc-Plated G100 Load Chain
- Compact Design with Low Headroom Perfect for a Wide Range of Uses
- Lightweight Aluminum Frame Design for Ultimate Portability
- Reliable and Stable Double Pawl Brake System, Tested at 125% of Load Capacity
- 3 Year Warranty, Customer Support and Service in the USA

Mini Lever Chain Hoist Description

The **Prowinch Mini 1/2 ton Lever Chain Hoist** features a lightweight aluminum design. It is perfect for warehouses, auto shops, and garages. It can be conveniently used in locations that do not have an electrical connection. The convenient, durable hook allows the hoist to be easily mounted wherever it is needed.

Prowinch Lever Chain Hoist

All of our **Lever Chain Hoists** are created with the goal of offering the best price-performance ratio. Key components such as lifespan factors are constantly tested and improved in order to offer the best product for the price.

Braking System

The reliable double pawl brake system is tested at 125% of the hoist capacity.

Technical Specifications

Rated Load Capacity	1102 lb / 500 kg	Load Chain Size	Ø 4.32 mm
Standard Lifting Height	5 ft / 1.5 m	Chain Falls	1
Capacity Range	1	Standards Compliance	ANSI/ASME B30.21, EN13157, ISO 16877-2008
Lever Force	53 lb / 24 kg	Warranty	3 Year
Load Chain Type	G100		

Model/Modelo	PWKX025	PWKX050	PWKX075	PWKX150
A	3.4 in / 86.36 mm	4.0 in / 101.6 mm	4.1 in / 104.14 mm	4.8 in / 121.9 mm
B	2.7 in / 68.58 mm	3.2 in / 81.28 mm	3.6 in / 91.44 mm	4.3 in / 109.22 mm
E	2.2 in / 55.88 mm	2.5 in / 23.5 mm		2.7 in / 68.58 mm
F	1.4 in / 35.56 mm	1.7 in / 43.2 mm		2.0 in / 50.8 mm
G	0.8 in / 20.32 mm	1.0 in / 25.4 mm	1.1 in / 27.94 mm	1.4 in / 35.56 mm
S	1.3 in / 33.02 mm	1.4 in / 35.56 mm		1.7 in / 43.18 mm
T	0.4 in / 10.16 mm	0.5 in / 12.7 mm	0.6 in / 15.24 mm	0.8 in / 20.32 mm
Length of Lever Handle "D"	6 in / 152.4 mm		7 in / 177.8 mm	9 in / 228.6 mm
Dimensión del Mango de la Palanca "D"				
Headroom "C"	0.7 ft / 0.21 m	0.8 ft / 0.24 m	0.9 ft / 0.27 m	1.1 ft / 0.34 m
Espacio Superior "C"				

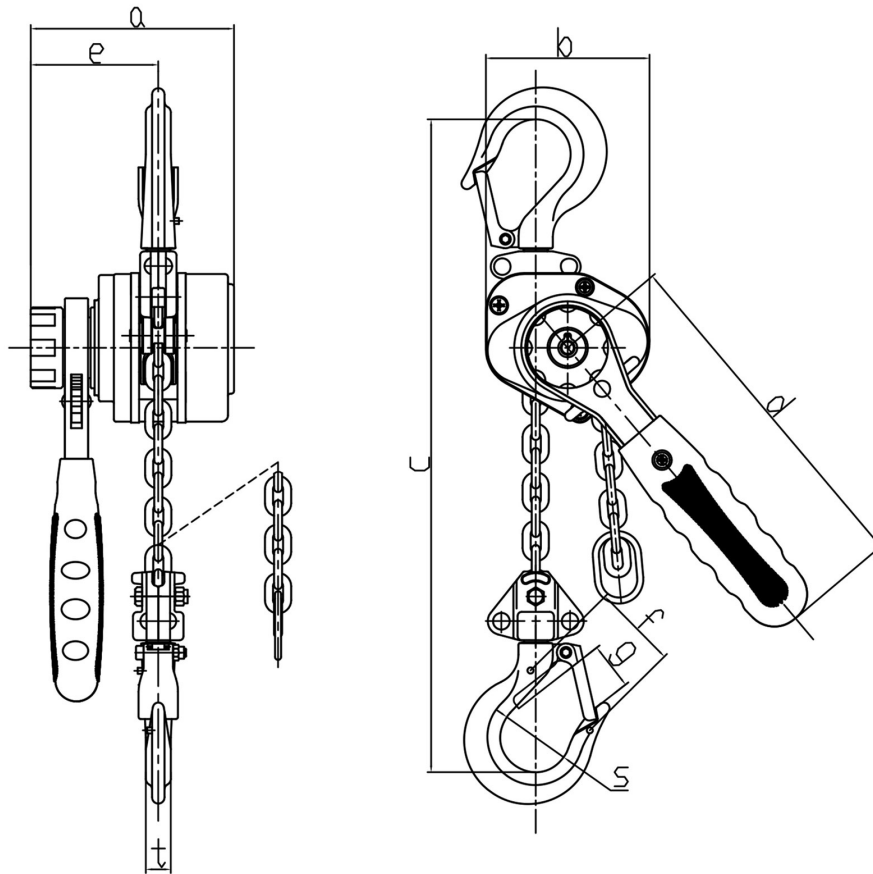

Unit Weight & Dimensions

D Depth	3.2 in / 81 mm
W Width	4 in / 101 mm
Total Unit Weight	4 lbs / 2 Kg

Packaging Weight & Dimensions

Package 1 Net Weight	4 lbs / 2 Kg
Package 1 Width	4 in / 10.16 cm
Package 1 Gross Weight	4 lbs / 2 Kg
Package 1 Height	3 in / 7.62 cm
Package 1 Length	9 in / 22.86 cm