



1/4 Ton Mini Lever Chain Hoist 5 ft. G100 Chain

Key features

- **Lifting Capacity:** Supports loads up to 1/4 ton, making it ideal for lighter lifting and pulling tasks.
- **Lifting Height:** Provides a maximum lifting height of 5 feet, suitable for various operational needs.
- **Durable Construction:** Built from high-quality materials for long-lasting performance, even in demanding conditions.
- **3 Year Warranty, Customer Support and Service in the USA**

1/4 Ton Mini Lever Chain Hoist Description

The 1/4 Ton Mini Lever Chain Hoist is a compact and lightweight lifting solution designed for small to medium-duty applications. Featuring a 5-foot lifting height and constructed with high-quality G100 chain, this mini hoist is perfect for tight spaces and precise lifting tasks.

Prowinch Lever Chain Hoist

All of our **Lever Chain Hoists** are created with the goal of offering the best price-performance ratio. Key components such as lifespan factors are constantly tested and improved in order to offer the best product for the price.

Braking System

The reliable double pawl brake system is tested at 125% of the hoist capacity.

Technical Specifications

Rated Load Capacity	551 lb / 250 kg	Load Chain Size	Ø 3.3 mm
Standard Lifting Height	5 ft / 1.5 m	Chain Falls	1
Lever Force	44 lbs / 20 kg	Standards Compliance	ANSI/ASME B30.21, EN13157, ISO 16877-2008
Load Chain Type	G100	Warranty	3 Year

Model/Modelo	PWKX025	PWKX050	PWKX075	PWKX150
A	3.4 in / 86.36 mm	4.0 in / 101.6 mm	4.1 in / 104.14 mm	4.8 in / 121.9 mm
B	2.7 in / 68.58 mm	3.2 in / 81.28 mm	3.6 in / 91.44 mm	4.3 in / 109.22 mm
E	2.2 in / 55.88 mm	2.5 in / 23.5 mm		2.7 in / 68.58 mm
F	1.4 in / 35.56 mm	1.7 in / 43.2 mm		2.0 in / 50.8 mm
G	0.8 in / 20.32 mm	1.0 in / 25.4 mm	1.1 in / 27.94 mm	1.4 in / 35.56 mm
S	1.3 in / 33.02 mm	1.4 in / 35.56 mm		1.7 in / 43.18 mm
T	0.4 in / 10.16 mm	0.5 in / 12.7 mm	0.6 in / 15.24 mm	0.8 in / 20.32 mm
Length of Lever Handle "D"	6 in / 152.4 mm		7 in / 177.8 mm	9 in / 228.6 mm
Dimensión del Mango de la Palanca "D"				
Headroom "C"	0.7 ft / 0.21 m	0.8 ft / 0.24 m	0.9 ft / 0.27 m	1.1 ft / 0.34 m
Espacio Superior "C"				

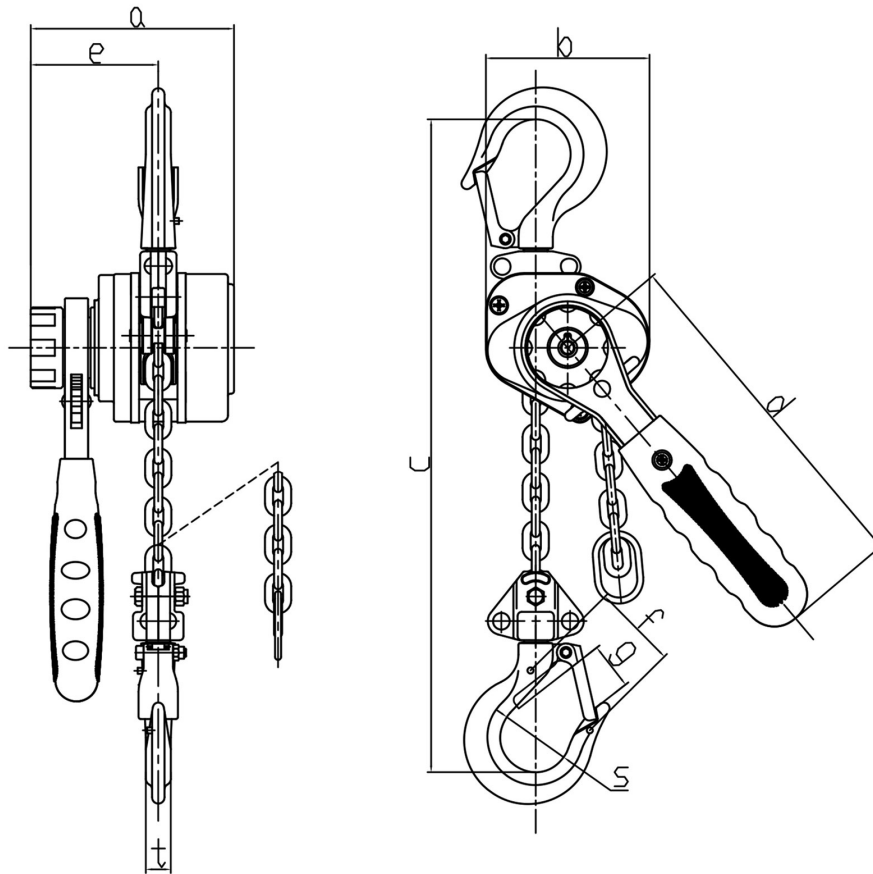

Unit Weight & Dimensions

D Depth	2.7 in / 68 mm
W Width	3.4 in / 86 mm
Total Unit Weight	2 lbs / 1 Kg

Packaging Weight & Dimensions

Package 1 Net Weight	2 lbs / 1 Kg
Package 1 Width	3 in / 7.62 cm
Package 1 Gross Weight	2 lbs / 1 Kg
Package 1 Height	3 in / 7.62 cm
Package 1 Length	7 in / 17.78 cm