



5 ton 11000 lb 208~240/440~480V 2 Speed Electric Chain Hoist Power Trolley 30 ft. FEC G80 Japan Chain H4 Duty Wireless

Key features

- Capacity: 5 tons (11,000 lbs)
- Voltage: 208~240/440~480V, dual voltage compatible for versatile industrial use
- Speed: 2-speed control, offering variable lifting speeds for precise handling
- 3 Year Warranty, Customer Support and Service in the USA

Electric Chain Hoist Description

This 5-ton (11,000 lb) electric chain hoist is engineered for industrial applications requiring both power and precision. With dual voltage capabilities (208~240/440~480V), this hoist offers flexibility across various power supplies. The hoist features a 2-speed motor, allowing smooth, controlled lifting and lowering operations for heavy loads. It comes equipped with a 30 ft. FEC G80 Japan chain, recognized for its superior strength and reliability, meeting H4 duty standards for high-demand environments. The integrated power trolley provides seamless movement along beams, while the wireless remote control ensures safe and efficient operation from a distance. This hoist is ideal for industrial facilities, construction sites, and warehouses.

Prowinch Two Speed Electric Chain Hoist with Power Trolley

All of our Electric Chain Hoists are created with the goal of offering the best price-performance ratio. Key components such as lifespan factors are constantly tested and improved in order to offer the best product for the price.

Key Components

All internal components have been upgraded to meet the highest quality standards. Key electronic components are produced by American or German brands, and we use American-made lubricants to ensure the lifespan of gears and reducers. Final assembly and all tests are performed in the US before shipping to ensure that every unit meets the corresponding standard.

Duty Classification

Duty Classification is a key factor when choosing the right unit. These H4 hoists are suitable for high-volume handling in steel warehouses, machine shops, fabricating plants and mills, and foundries. For uniformly distributed work periods, the hoists have 50% max. operational time per hour and can handle up to 300 starts per hour. When being used for infrequent work periods, the hoist can be operated for 30 minutes from a cold start with up to 300 starts per hour. Operational time ratings are calculated at a 65% load factor, as per ASME HST-1-2012.

Control System

This electric chain hoist comes standard with an industrial wireless remote control and a pendant control. The length of the pendant control is 4 feet less than the lifting height, which allows it to be easily operated from ground-level.

Braking System

The electromagnetic brake system is tested at 125% of the hoist capacity and is designed to automatically engage immediately upon any loss of power.

Technical Specifications

UL File	MSXT.E528915 - Hoists	Control	Wireless PW-Q404 and Pendant Control
Rated Load Capacity	11000 lbs / 5000 kg	Control Voltage	24V
Standard Lifting Height	30 ft / 9 m	Emergency Stop	Yes
Speed (f/m) / min	1.0 / 3.0 m/min	Load Chain Type	G80 JAPAN
Number of Speeds	2 Speed	Load Chain Size	11.2 x 34 mm
Voltage	3 Phase 208~240/440~480V 50/60Hz	Chain Falls	2
USA and Canada Voltage	208~240/440~480V	Chain Length	30 ft / 9 m
Available Voltages	208~240/440~480V for USA and 380/440~480V for CHILE	Humidity	<85%
Total Power Watts	3000	Temperature	-4 ~ 104° F / -20 ~ 40° C
FCC ID	2AZMK-Q1212	Noise Level	81 dB
Duty Class	H4/M5/2m/Class D	Trolley Number of Speeds	1
Motor Power (6)	3 kW	I-Beam Width Range	5 - 7 inches
Motor Brake	Yes	Standards Compliance	UL 1340, ASME HST-1 , ASME B30.16 , B30.17, EN60204-32
Insulation Grade	F	Warranty	3 Year
IEC Motor Protection	IP55		

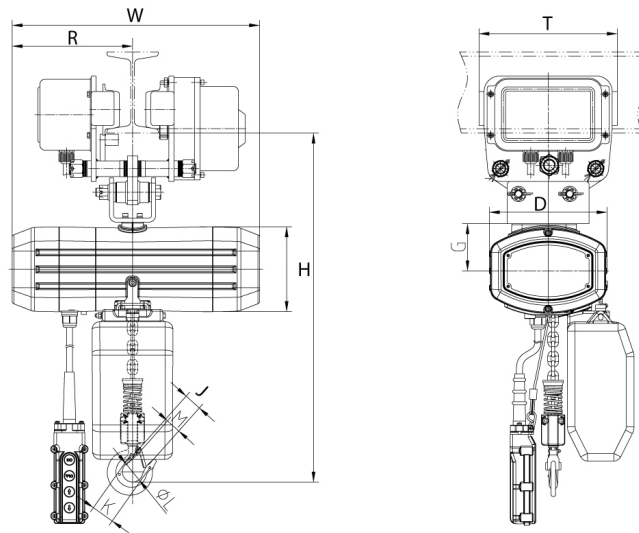

Unit Weight & Dimensions

T Trolley Motor Width	4.33 in / 11.0 cm
W Width	27.5 in / 69.4 cm
H Minimum Headroom	34 in / 86 cm
J Hook Opening	2.72 in / 6.9 cm
D Depth	14 in / 35 cm