



5 ton 11000 lb 208~240/440~480V 1 Speed Electric Chain Hoist Power Trolley 30 ft. FEC G80 Japan Chain H4 Duty Wireless

Key features

- Load Capacity: 5 tons (11,000 lbs)
- Voltage: 208~240/440~480V, adaptable to various industrial power systems
- Speed: 1-speed operation for consistent and reliable lifting
- 3 Year Warranty, Customer Support and Service in the USA

Electric Chain Hoist Description

This 5-ton (11,000 lb) electric chain hoist is designed for industrial-grade lifting operations, offering a robust single-speed performance. The hoist is compatible with dual voltage options (208~240/440~480V) to suit different electrical setups. Equipped with a 30 ft FEC G80 Japan chain, known for its high tensile strength and durability, this hoist is built to withstand heavy use, adhering to H4 duty classification for demanding environments. The integrated power trolley enables efficient horizontal load movement, while the wireless remote control ensures safe, easy, and precise operation from a distance. Ideal for warehouses, construction, and manufacturing settings.

Technical Specifications

Rated Load Capacity	11000 lbs / 5000 kg	Control Voltage	24V
Standard Lifting Height	30 ft / 9 m	Emergency Stop	Yes
Number of Speeds	1 Speed	Load Chain Type	G80 JAPAN
Voltage	3 Phase 208~240/440~480V 50/60Hz	Load Chain Size	11.2 x 34 mm
USA and Canada Voltage	208~240/440~480V	Chain Falls	2
Available Voltages	208~240/440~480V for USA and 380/440~480V for CHILE	Chain Length	60 ft / 18 m
FCC ID	2AZMK-Q1212	Humidity	<85%
Duty Class	H4/M5/2m/Class D	Temperature	-4 ~ 104° F / -20 ~ 40° C
Motor Power (6)	3 kW	Noise Level	81 dB
Motor Brake	Yes	I-Beam Width Range	5 - 7 inches
Insulation Grade	F	Standards Compliance	UL 1340, ASME HST-1 , ASME B30.16 , B30.17, EN60204-32
IEC Motor Protection	IP55	Warranty	3 Year
Control	Wireless PW-Q400 and Pendant Control		

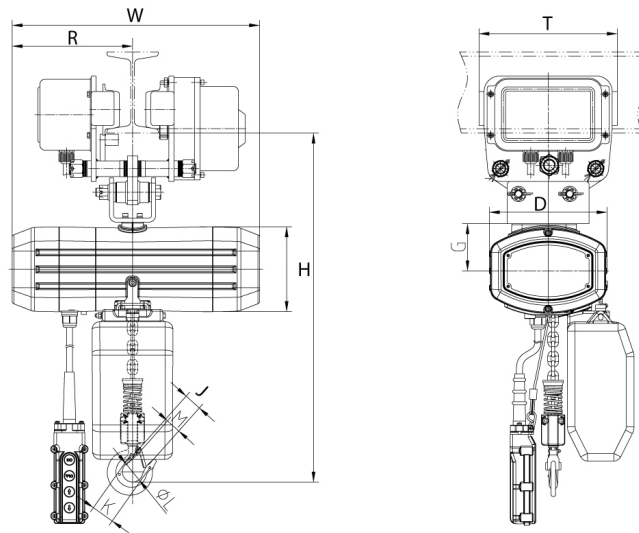

Unit Weight & Dimensions

T Trolley Motor Width	4.33 in / 11.0 cm
W Width	27.5 in / 69.4 cm
H Minimum Headroom	34 in / 86 cm
J Hook Opening	2.72 in / 6.9 cm
D Depth	14 in / 35 cm