



3 ton 6600 lb 220~240/460V 2 Speed Electric Chain Hoist Power Trolley 30 ft. FEC G80 Japan Chain H4 Duty Wireless

Key features

- Load Capacity: 3 tons (6,600 lbs)
- Voltage: 220~240V / 460V, adaptable for different power requirements
- Speed: 2-speed control for versatile operation
- 3 Year Warranty, Customer Support and Service in the USA

Electric Chain Hoist Description

This heavy-duty 3-ton (6600 lb) electric chain hoist is equipped with a versatile 2-speed mechanism for precise control and flexibility in lifting operations. It operates on dual voltage options (220~240V or 460V), making it adaptable to different electrical systems. Featuring a durable 30 ft FEC G80 Japan chain, this hoist is built for high performance and reliability, meeting the H4 duty rating for demanding industrial applications. The integrated power trolley allows smooth horizontal movement, while the wireless control enhances operational convenience and safety, making this hoist an ideal choice for complex and high-load lifting tasks.

Prowinch Two Speed Electric Chain Hoist with Power Trolley

All of our Electric Chain Hoists are created with the goal of offering the best price-performance ratio. Key components such as lifespan factors are constantly tested and improved in order to offer the best product for the price.

Key Components

All internal components have been upgraded to meet the highest quality standards. Key electronic components are produced by American or German brands, and we use American-made lubricants to ensure the lifespan of gears and reducers. Final assembly and all tests are performed in the US before shipping to ensure that every unit meets the corresponding standard.

Duty Classification

Duty Classification is a key factor when choosing the right unit. These H4 hoists are suitable for high-volume handling in steel warehouses, machine shops, fabricating plants and mills, and foundries. For uniformly distributed work periods, the hoists have 50% max. operational time per hour and can handle up to 300 starts per hour. When being used for infrequent work periods, the hoist can be operated for 30 minutes from a cold start with up to 300 starts per hour. Operational time ratings are calculated at a 65% load factor, as per ASME HST-1-2012.

Control System

This electric chain hoist comes standard with an industrial wireless remote control and a pendant control. The length of the pendant control is 4 feet less than the lifting height, which allows it to be easily operated from ground-level.

Braking System

The electromagnetic brake system is tested at 125% of the hoist capacity and is designed to automatically engage immediately upon any loss of power.

Technical Specifications

Rated Load Capacity	6600 lbs / 3000 kg	Control	Wireless PW-Q404 and Pendant Control
Standard Lifting Height	30 ft / 9 m	Control Voltage	24V
Speed (f/m) / min	2.0 / 6.0 m/min	Emergency Stop	Yes
Number of Speeds	2 Speed	Load Chain Type	G80 JAPAN
Voltage	3 Phase 208~240/440~480V 50/60Hz	Load Chain Size	11.2 x 34 mm
USA and Canada Voltage	208~240/440~480V	Chain Falls	1
Available Voltages	208~240/440~480V for USA and 380/440~480V for CHILE	Chain Length	30 ft / 9 m
Total Power Watts	3000	Humidity	<85%
FCC ID	2AZMK-Q1212	Temperature	-4 ~ 104° F / -20 ~ 40° C
Duty Class	H4/M5/2m/Class D	Noise Level	81 dB
Motor Power (6)	3 kW	Trolley Number of Speeds	1
Motor Brake	Yes	I-Beam Width Range	5 - 7 inches
Insulation Grade	F	Standards Compliance	UL 1340, ASME HST-1 , ASME B30.16 , B30.17, EN60204-32
IEC Motor Protection	IP55	Warranty	3 Year

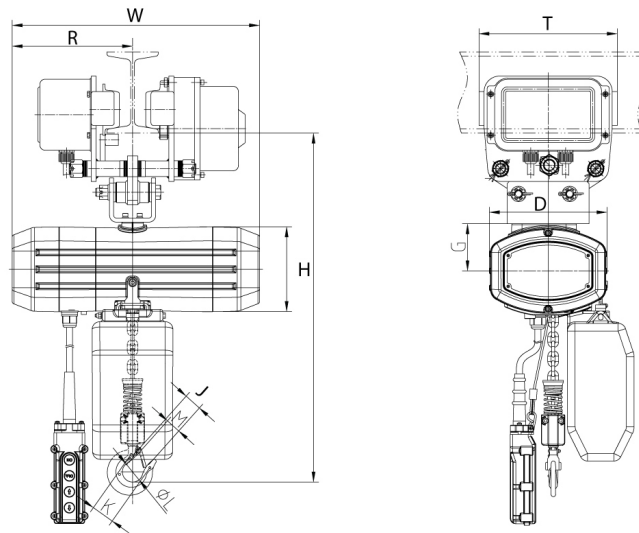

Unit Weight & Dimensions

T Trolley Motor Width	6.9 in / 16.5 cm
W Width	27.5 in / 69.4 cm
H Minimum Headroom	23 in / 57.5 cm
J Hook Opening	1.53 in / 3.9 cm
D Depth	14 in / 35 cm