



## 3 ton 6600 lb 208~240/440~480V 1 Speed Electric Chain Hoist Power Trolley 30 ft. FEC G80 Japan Chain H4 Duty Wireless

### Key features

- Load Capacity: 3 tons (6,600 lbs) - high lifting capability for substantial loads.
- Voltage: 208~240/440~480V - adaptable to different power supplies.
- Speed: 1-speed setting - provides straightforward operation.
- 3 Year Warranty, Customer Support and Service in the USA

### Electric Chain Hoist Description

This robust 3-ton (6600 lb) electric chain hoist is designed for heavy-duty lifting with a single-speed operation. It operates on dual voltage options (208~240/440~480V), providing flexibility to suit various electrical systems. The hoist features a 30 ft FEC G80 Japan chain, ensuring strength and durability for demanding tasks, and has an H4 duty rating for high-performance use. The included power trolley allows smooth and efficient horizontal movement. With wireless control, it offers enhanced operational convenience and safety, making it ideal for industrial applications requiring reliable and efficient lifting solutions.

## Technical Specifications

<b>Rated Load Capacity</b>	6600 lbs / 3000 kg	<b>Control Voltage</b>	24V
<b>Standard Lifting Height</b>	30 ft / 9 m	<b>Emergency Stop</b>	Yes
<b>Number of Speeds</b>	1 Speed	<b>Load Chain Type</b>	G80 JAPAN
<b>Voltage</b>	3 Phase 208~240/440~480V 50/60Hz	<b>Load Chain Size</b>	11.2 x 34 mm
<b>USA and Canada Voltage</b>	208~240/440~480V	<b>Chain Falls</b>	1
<b>Available Voltages</b>	208~240/440~480V for USA and 380/440~480V for CHILE	<b>Chain Length</b>	30 ft / 9 m
<b>FCC ID</b>	2AZMK-Q1212	<b>Humidity</b>	<85%
<b>Duty Class</b>	H4/M5/2m/Class D	<b>Temperature</b>	-4 ~ 104° F / -20 ~ 40° C
<b>Motor Power (6)</b>	3 kW	<b>Noise Level</b>	81 dB
<b>Motor Brake</b>	Yes	<b>I-Beam Width Range</b>	5 - 7 inches
<b>Insulation Grade</b>	F	<b>Standards Compliance</b>	UL 1340, ASME HST-1 , ASME B30.16 , B30.17, EN60204-32
<b>IEC Motor Protection</b>	IP55	<b>Warranty</b>	3 Year
<b>Control</b>	Wireless PW-Q400 and Pendant Control		

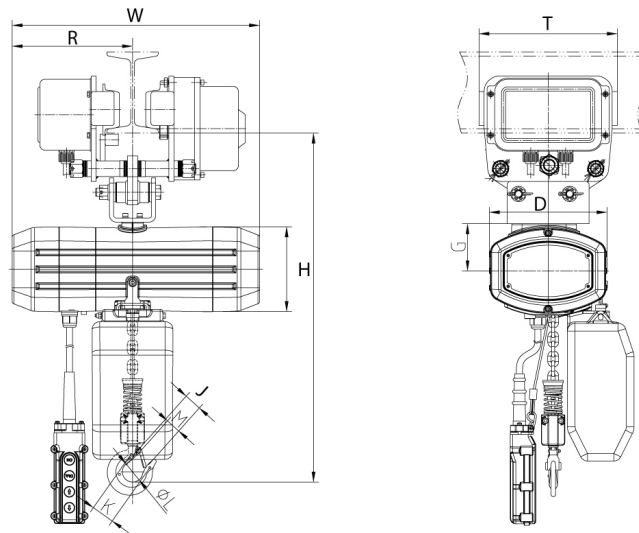

## Unit Weight & Dimensions

<b>T Trolley Motor Width</b>	6.9 in / 16.5 cm
<b>W Width</b>	27.5 in / 69.4 cm
<b>H Minimum Headroom</b>	23 in / 57.5 cm
<b>J Hook Opening</b>	1.53 in / 3.9 cm
<b>D Depth</b>	14 in / 35 cm