

## Grooved Drum for PWG7700

### Key features

- **Designed for PWG7700:** Specifically engineered for the PWG7700 winch, guaranteeing a perfect fit and compatibility for seamless integration.
- **Durable Construction:** Crafted from high-quality materials to withstand the rigors of heavy-duty use, ensuring long-lasting reliability and performance.
- **Grooved Design:** Features strategically placed grooves to maintain proper cable alignment, reducing wear and preventing tangling during operation.
- **3 Year Warranty, Customer Support and Service in the USA**

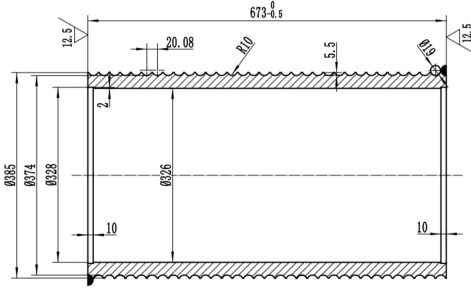

### Grooved Drum for PWG7700 Description

The Grooved Drum for the PWG7700 winch is a key component designed to optimize cable management and enhance the overall performance of your winching system. This drum ensures smooth and efficient operation, making it ideal for various heavy-duty lifting and pulling applications.

## Technical Specifications

<b>Warranty</b>	3 Year
-----------------	--------

## Unit Weight & Dimensions

<b>Total Unit Weight</b>	242 lbs / 110 Kg
--------------------------	------------------

## Packaging Weight & Dimensions

<b>Package 1 Net Weight</b>	242 lbs / 110 Kg
-----------------------------	------------------

<b>Package 1 Width</b>	31 in / 78.74 cm
------------------------	------------------

<b>Package 1 Gross Weight</b>	242 lbs / 110 Kg
-------------------------------	------------------

<b>Package 1 Height</b>	19 in / 48.26 cm
-------------------------	------------------

<b>Package 1 Length</b>	19 in / 48.26 cm
-------------------------	------------------