



10 Ton Geared Trolley Ex series spark resistant

Key features

- Capacity: Supports loads up to 10 tons (20,000 lbs) for demanding lifting tasks.
- Geared Mechanism: Provides precise control and smooth movement for enhanced usability.
- Versatile Compatibility: Suitable for various beam sizes, allowing for flexible installation.
- 3 Year Warranty, Customer Support and Service in the USA

Explosion Proof Description

The 10 Ton Geared Trolley from the Ex Series is specifically designed for safe and efficient use in hazardous environments. This heavy-duty trolley features spark-resistant components, making it ideal for applications in explosive atmospheres. With a robust capacity of 10 tons, it ensures reliable performance and smooth operation for moving heavy loads along beams.

Technical Specifications

Rated Load Capacity	10 Ton / 22000 lbs	I-Beam Width Range	125 - 190 mm [4.92 - 7.48 in]
Load Test	125% [Rated Load / Capacidad Nominal]	Minimum Turn Radius	3.0 m [9.84 ft]
Standard Lifting Height	20 ft / 6 m	Standards Compliance	ASME B30.17 / ATEX Directive
Explosion Proof Protection	Ex II 2 GD c II B T105 °C	Made in	Japan
Control	Geared Manual Chain	Warranty	3 Year
Hand Chain Height (Customizable)	6 m / 20 ft		

Capacity / Capacidad	A	B	C	D	E	F	H	I	J	K
1102 lb / 0.5 t	7.50 in / 191 mm	5.0 in / 127 mm	2.9 in / 74 mm	6.1 in / 155 mm	2.7 in / 69 mm	3.9 in / 99 mm	4.2 in / 107 mm	1.3 in / 33 mm	1.1 in / 33 mm	3.9 in / 99 mm
2204 lb / 1 t	8.70 in / 221 mm	5.0 in / 127 mm	2.9 in / 74 mm	6.7 in / 170 mm	3.1 in / 79 mm	4.5 in / 114 mm	4.4 in / 112 mm	1.2 in / 30 mm	1.1 in / 28 mm	4.0 in / 102 mm
3527 lb / 1.5 t	10.2 in / 262 mm	5.6 in / 142 mm	3.7 in / 94 mm	8.1 in / 206 mm	3.8 in / 97 mm	5.3 in / 135 mm	5.9 in / 150 mm	2.0 in / 51 mm	1.5 in / 38 mm	5.5 in / 140 mm
4409 lb / 2 t	10.2 in / 260 mm	5.6 in / 142 mm	3.7 in / 94 mm	8.1 in / 206 mm	3.8 in / 97 mm	5.3 in / 135 mm	5.9 in / 150 mm	2.1 in / 53 mm	1.5 in / 38 mm	5.5 in / 140 mm
6944 lb / 3 t	11.3 in / 287 mm	5.7 in / 145 mm	3.8 in / 97 mm	9.4 in / 239 mm	4.5 in / 114 mm	5.9 in / 150 mm	7.1 in / 180 mm	2.5 in / 64 mm	1.9 in / 48 mm	6.6 in / 168 mm
11023 lb / 5 t	12.9 in / 328 mm	6.5 in / 165 mm	4.9 in / 124 mm	11.4 in / 290 mm	4.9 in / 124 mm	6.6 in / 167 mm	8.7 in / 221 mm	2.9 in / 74 mm	2.3 in / 58 mm	8.2 in / 208 mm
17636 lb / 8 t	17.0 in / 432 mm	6.5 in / 165 mm	7.0 in / 178 mm	13.0 in / 330 mm	6.2 in / 157 mm	8.6 in / 218 mm	9.6 in / 243 mm	3.9 in / 99 mm	3.1 in / 79 mm	9.1 in / 231 mm
22046 lb / 10 t	17.0 in / 432 mm	7 in / 178 mm		13.0 in / 330 mm	6.2 in / 157 mm	8.6 in / 218 mm	9.6 in / 243 mm	3.9 in / 99 mm	3.1 in / 79 mm	9.1 in / 231 mm
33069 lb / 15 t	22.8 in / 579 mm	9 in / 229 mm		18.2 in / 462 mm	7.7 in / 196 mm	11.6 in / 295 mm	10.7 in / 272 mm	3.3 in / 84 mm	3.7 in / 94 mm	9.7 in / 246 mm
44092 lb / 20 t	22.8 in / 579 mm	9 in / 229 mm		18.2 in / 462 mm	7.7 in / 196 mm	11.6 in / 295 mm	10.7 in / 272 mm	3.3 in / 84 mm	3.7 in / 94 mm	9.7 in / 246 mm

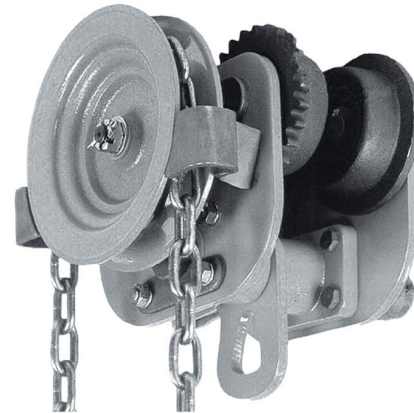
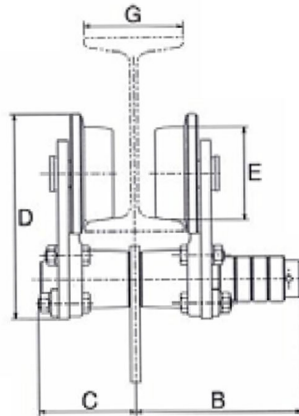
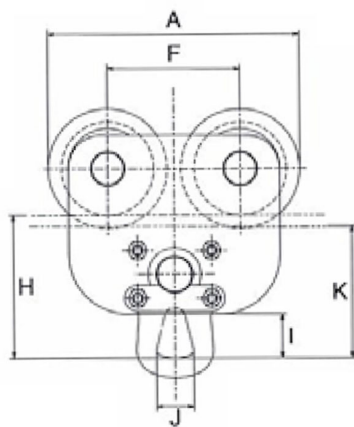

Referential Images
Specifications may change without notice

Unit Weight & Dimensions

H Minimum Headroom	798 mm [31.4 in] Combined Hoist Trolley
X Wheels Diameter	158 mm [6.2 in]
Total Unit Weight	257 lbs / 117 Kg

Packaging Weight & Dimensions

Hand Chain Size	5 x 23.6
Package 1 Net Weight	257 lbs / 117 Kg